

- - - - - ETJ BOUNDARY
- - - - - CITY LIMITS

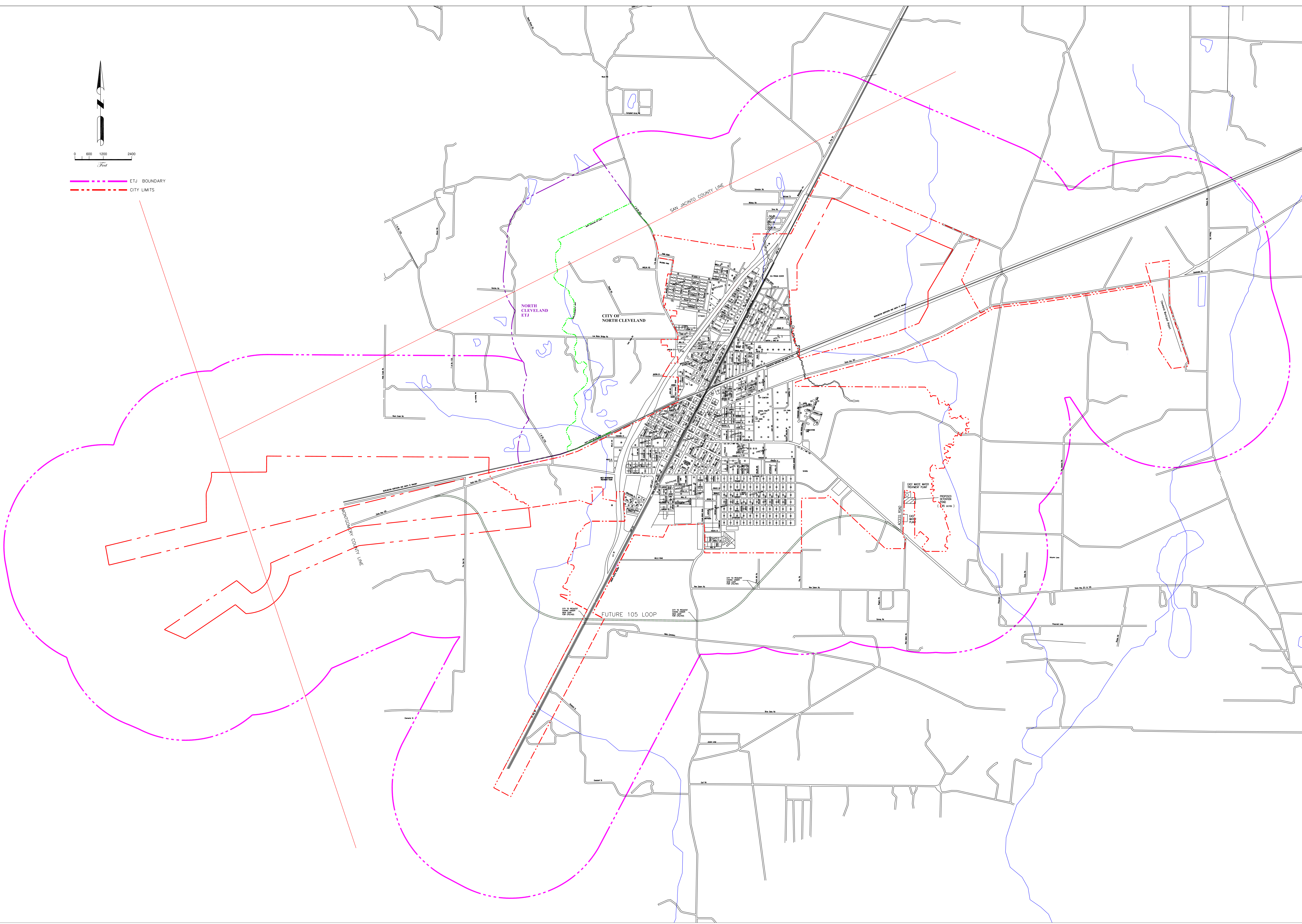

Prepared by
PUBLIC MANAGEMENT, INC.
 P.O. Box 1827
 Cleveland, Texas 77328-1827
 (281) 592-0439

THE PREPARATION OF THIS DOCUMENT WAS FINANCED THROUGH
 PROCEEDS OF A TEXAS COMMUNITY DEVELOPMENT PROGRAM
 GRANT FROM THE U.S. DEPARTMENT OF
 HOUSING AND URBAN DEVELOPMENT.
 FINANCED THROUGH THE OFFICE
 OF RURAL AND COMMUNITY AFFAIRS
 OF THE STATE OF TEXAS.

By	Revision	Date Revised
T.E.	Revised as per comments	4-15-03
T.E.	Revised as per Annexed area	1/20/05
T.E.	Revised as per Annexed area	3/25/2010

EXHIBIT
B

2010
CITY OF CLEVELAND, TEXAS
BASE MAP