

**Legend**

- Proposed Water Lines
- Large 6" Waterlines
- Small 2" Waterlines
- Pipelines at Airport EDC
- Booster Pumps
- Fire Hydrants
- Storage Tanks
- Water Wells
- Major Roadways
- Proposed Road Improvements
- Airport
- City Limits 2018
- Major Easements
- Railroads
- North Cleveland Boundary
- ETJ 2017
- Lakes/Rivers

**Legend**

- New EST on Northside
- New EST - Grand Oaks
- Connect Plant #4
- Extend Service along Hwy 59-Travis
- MUD #1 Location - Pinewood Trails
- New Well near Plant #5

0 0.5 1 2 Miles

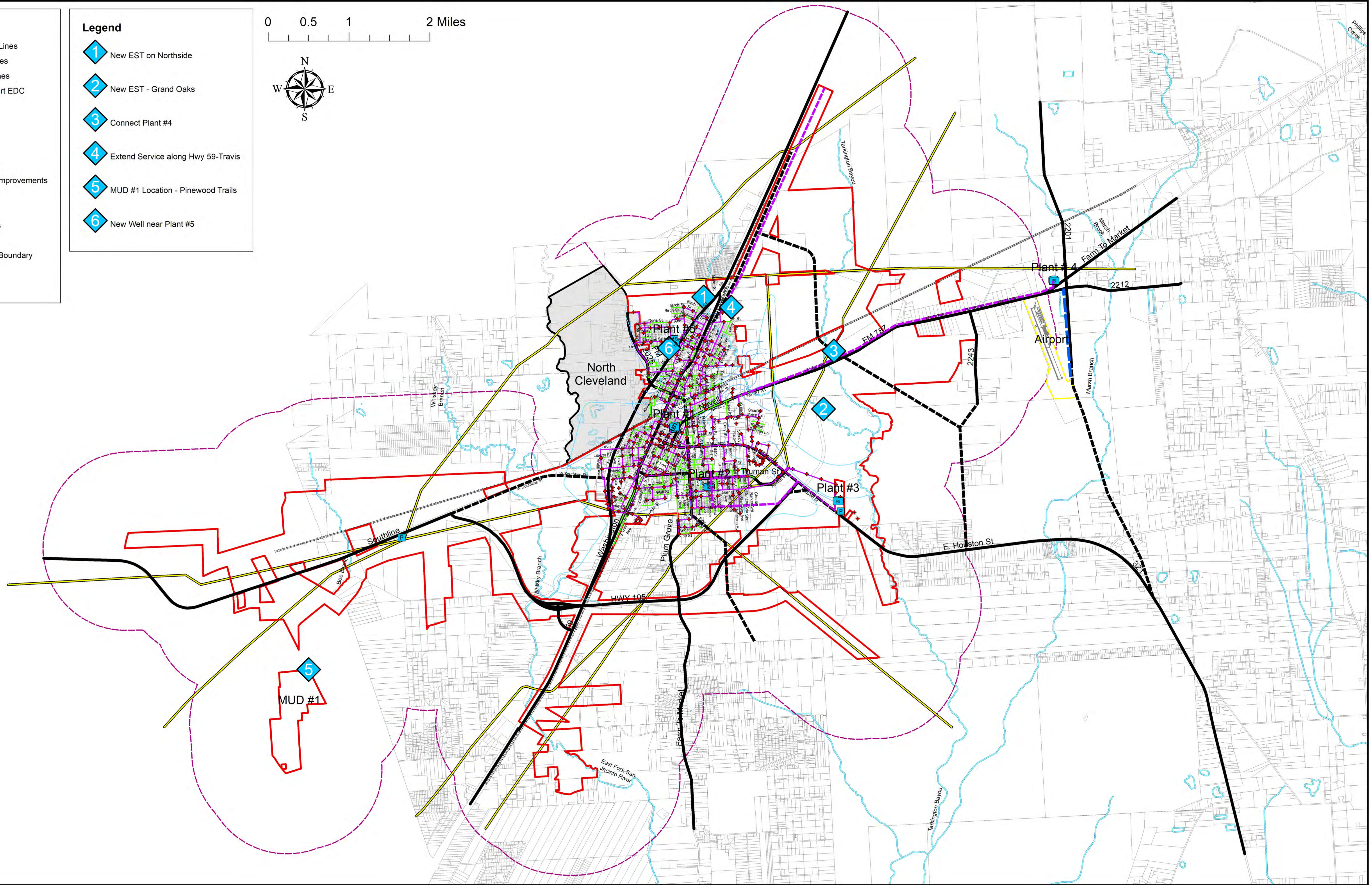
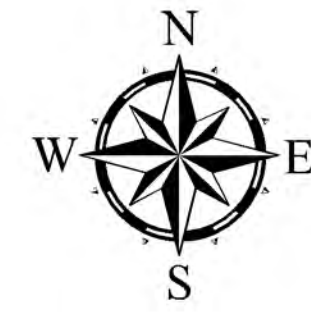

**WATER SYSTEMS 1**

**CITY OF CLEVELAND**

CLEVELAND, TX



All map data should be considered as preliminary, in need of verification, and subject to change. This exhibit is conceptual in nature and does not represent any regulatory approval. Plan is subject to change.